



# Lewington Road FISHPONDS

APPROXIMATE FLOOR AREA  
82 SQM / 876 SQFT



GROUND FLOOR

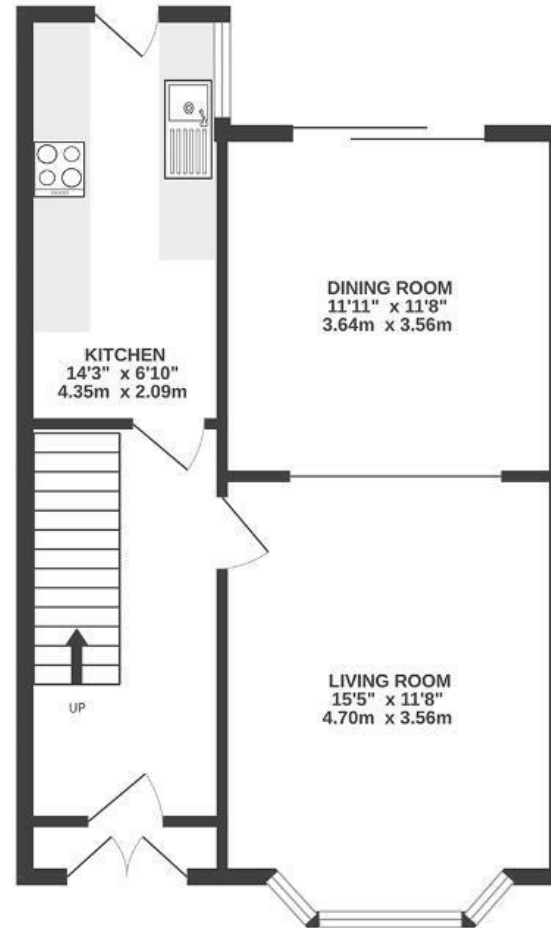

FIRST FLOOR

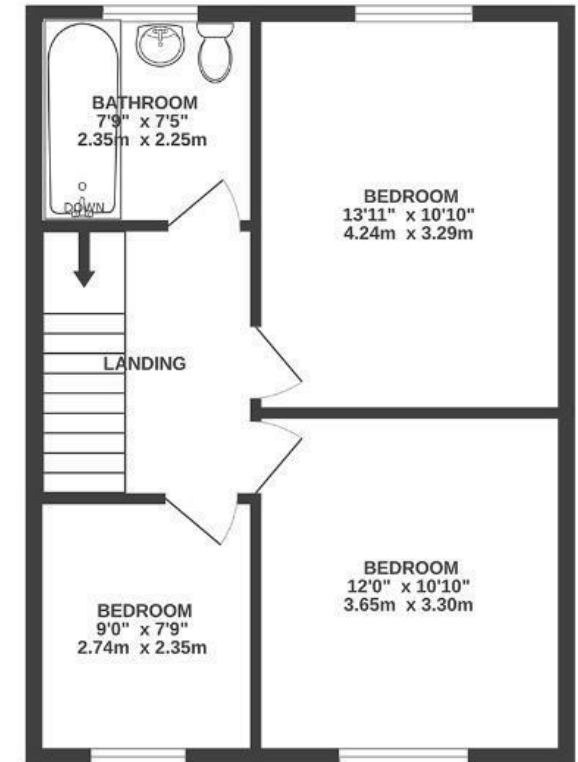

Boardwalk

# Lewington Road

FISHPONDS, BRISTOL



£350,000



3 Bedrooms



BS16 4AA



1 Bathrooms

*"We love working from home in this wonderful house that has been an incredible opportunity to get on the ladder. The high speed internet at the address allows us to both work to a high standard, and with Snuff Mills close by, we are able to pop out for walks, coffee and get fresh air when we need it."*

